

No.	REVISIONS	DATE	BY	APR DATE

2025 KIMLEY-HORN AND ASSOCIATES, INC.
 7965 N. HIGH STREET, SUITE 200
 COLUMBUS, OH 43235
 WWW.KIMLEY-HORN.COM
 PHONE: 614-454-8699

SCALE: AS NOTED
 DESIGNED BY: JAB
 DRAWN BY: AGH
 CHECKED BY: SDM

CLARKSHAW VILLAGE
 IMPROVEMENT PLAN
 STREET, STORM, AND WATER
 CONCORD TOWNSHIP
 DELAWARE COUNTY, OH

ORIGINAL ISSUE:
 2/26/2026
 KHA PROJECT NO.
 190275001
 SHEET NUMBER
1
 OF 44

FINAL ENGINEERING PLAN FOR CLARKSHAW VILLAGE

SECTION 1, PHASES A, B, & C
 FARM LOTS 23, 24 & 25
 SECTION 3, TOWNSHIP 4, RANGE 19
 UNITED STATES MILITARY DISTRICT
 TOWNSHIP OF CONCORD, COUNTY OF DELAWARE, STATE OF OHIO

Sheet Number	Sheet Title
1	TITLE SHEET
2	GENERAL NOTES
3	TYPICAL SECTIONS
4	QUANTITIES & MISCELLANEOUS DETAILS
5-6	DEL-CO WATER DETAILS
7-12	PLAN & PROFILE
13-16	GRADING PLAN
17	INTERSECTION DETAILS
18-25	CUL-DE-SAC DETAILS
26	STORM PROFILES
27-29	STORM PROFILES & STRUCTURE TABLES
30-32	DRAINAGE MAINTENANCE EXHIBIT
33	SEWAGE AND STRIPPING PLAN
34-35	STORMWATER POLLUTION PREVENTION PLAN - COVER AND DETAILS
36-37	STORMWATER POLLUTION PREVENTION PLAN - NOTES
38	LOCAL TRIBUTARY MAP
39-41	STORMWATER POLLUTION PREVENTION PLAN - PHASE 1
42-44	STORMWATER POLLUTION PREVENTION PLAN - PHASE 2
45	BASEIN DETAILS

BENCHMARKS

DATUM: NAVD 88
 BM #3
 RAILROAD SPIKE SET IN THE SOUTH FACE OF POWER POLE 20', NORTH OF CENTERLINE OF BEAN OLLER ROAD 2717', EAST OF INTERSECTION OF BEAN OLLER ROAD AND SOUTH SECTION LINE ROAD.
 ELEV=936.58'
 BM #4
 WHITE PAINTED SQUARE ON FLAT METAL 3' ABOVE GROUND ON NORTH POWER TOWER LEG 70' SOUTH OF CENTERLINE OF BEAN OLLER ROAD 3510' EAST OF INTERSECTION OF BEAN OLLER ROAD AND SOUTH SECTION LINE ROAD.
 ELEV=939.78'
 BM #5
 RAILROAD SPIKE IN SOUTH EAST FACE OF POWER POLE 27' NORTH OF CENTERLINE OF BEAN OLLER ROAD 4186' EAST OF INTERSECTION OF BEAN OLLER ROAD AND SOUTH SECTION LINE ROAD.
 ELEV=941.28'
 BM #6
 X-ON NORTH BOLT OF HYDRANT 27' NORTH OF CENTERLINE OF CLARKSHAW ROAD 3108' EAST OF INTERSECTION OF CLARKSHAW ROAD AND SOUTH SECTION LINE ROAD.
 ELEV=936.55'
 BM #7
 X-ON NORTH BOLT OF HYDRANT 22' NORTH OF CENTERLINE OF CLARKSHAW ROAD 3450' EAST OF INTERSECTION OF CLARKSHAW ROAD AND SOUTH SECTION LINE ROAD.
 ELEV=937.89'

VARIANCES

1. TO ARTICLE IV, SECTION 403 PART B, REMOVE CROSS SECTION REQUIREMENTS FOR CURB AND GUTTER STREETS IN 3' OF FILL OR LESS. - APPROVED 9/23/2025
 2. MATCHING CROWN ON STORM SEWER PIPES SO THAT CROWN OF PIPES (AT THE JUNCTIONS) ARE AT THE SAME ELEVATION. APPLICABLE STRUCTURES (JUNCTIONS): 1, 2, 3, 4, 5, 9, 10, 12, 14, 15, 16, 17, 18, 19, 20, 21, 24, 27, 33, 34, 35, 39, 40, 65, 67, 68, 70, 73, 75, 76, 78, 80, 81, 82, 83, 84, 85, 86, 87, 88, 89, 90, 91, 92, 93, 94, 95, 96, 97, 98, 99, 100, 101, 102, 103, 104, 105, 106, 107, 108, 109, 110, 111, 112, 113, 114, 115, 116, 117, 118, 119, 120, 121, 122, 123, 124, 125, 126, 127, 128, 129, 130, 131, 132, 133, 134, 135, 136, 137, 138, 139, 140, 141, 142, 143, 144, 145, 146, 147, 148, 149, 150, 151, 152, 153, 154, 155, 156, 157, 158, 159, 160, 161, 162, 163, 164, 165, 166, 167, 168, 169, 170, 171, 172, 173, 174, 175, 176, 177, 178, 179, 180, 181, 182, 183, 184, 185, 186, 187, 188, 189, 190, 191, 192, 193, 194, 195, 196, 197, 198, 199, 200, 201, 202, 203, 204, 205, 206, 207, 208, 209, 210, 211, 212, 213, 214, 215, 216, 217, 218, 219, 220, 221, 222, 223, 224, 225, 226, 227, 228, 229, 230, 231, 232, 233, 234, 235, 236, 237, 238, 239, 240, 241, 242, 243, 244, 245, 246, 247, 248, 249, 250, 251, 252, 253, 254, 255, 256, 257, 258, 259, 260, 261, 262, 263, 264, 265, 266, 267, 268, 269, 270, 271, 272, 273, 274, 275, 276, 277, 278, 279, 280, 281, 282, 283, 284, 285, 286, 287, 288, 289, 290, 291, 292, 293, 294, 295, 296, 297, 298, 299, 300, 301, 302, 303, 304, 305, 306, 307, 308, 309, 310, 311, 312, 313, 314, 315, 316, 317, 318, 319, 320, 321, 322, 323, 324, 325, 326, 327, 328, 329, 330, 331, 332, 333, 334, 335, 336, 337, 338, 339, 340, 341, 342, 343, 344, 345, 346, 347, 348, 349, 350, 351, 352, 353, 354, 355, 356, 357, 358, 359, 360, 361, 362, 363, 364, 365, 366, 367, 368, 369, 370, 371, 372, 373, 374, 375, 376, 377, 378, 379, 380, 381, 382, 383, 384, 385, 386, 387, 388, 389, 390, 391, 392, 393, 394, 395, 396, 397, 398, 399, 400, 401, 402, 403, 404, 405, 406, 407, 408, 409, 410, 411, 412, 413, 414, 415, 416, 417, 418, 419, 420, 421, 422, 423, 424, 425, 426, 427, 428, 429, 430, 431, 432, 433, 434, 435, 436, 437, 438, 439, 440, 441, 442, 443, 444, 445, 446, 447, 448, 449, 450, 451, 452, 453, 454, 455, 456, 457, 458, 459, 460, 461, 462, 463, 464, 465, 466, 467, 468, 469, 470, 471, 472, 473, 474, 475, 476, 477, 478, 479, 480, 481, 482, 483, 484, 485, 486, 487, 488, 489, 490, 491, 492, 493, 494, 495, 496, 497, 498, 499, 500, 501, 502, 503, 504, 505, 506, 507, 508, 509, 510, 511, 512, 513, 514, 515, 516, 517, 518, 519, 520, 521, 522, 523, 524, 525, 526, 527, 528, 529, 530, 531, 532, 533, 534, 535, 536, 537, 538, 539, 540, 541, 542, 543, 544, 545, 546, 547, 548, 549, 550, 551, 552, 553, 554, 555, 556, 557, 558, 559, 560, 561, 562, 563, 564, 565, 566, 567, 568, 569, 570, 571, 572, 573, 574, 575, 576, 577, 578, 579, 580, 581, 582, 583, 584, 585, 586, 587, 588, 589, 590, 591, 592, 593, 594, 595, 596, 597, 598, 599, 600, 601, 602, 603, 604, 605, 606, 607, 608, 609, 610, 611, 612, 613, 614, 615, 616, 617, 618, 619, 620, 621, 622, 623, 624, 625, 626, 627, 628, 629, 630, 631, 632, 633, 634, 635, 636, 637, 638, 639, 640, 641, 642, 643, 644, 645, 646, 647, 648, 649, 650, 651, 652, 653, 654, 655, 656, 657, 658, 659, 660, 661, 662, 663, 664, 665, 666, 667, 668, 669, 670, 671, 672, 673, 674, 675, 676, 677, 678, 679, 680, 681, 682, 683, 684, 685, 686, 687, 688, 689, 690, 691, 692, 693, 694, 695, 696, 697, 698, 699, 700, 701, 702, 703, 704, 705, 706, 707, 708, 709, 710, 711, 712, 713, 714, 715, 716, 717, 718, 719, 720, 721, 722, 723, 724, 725, 726, 727, 728, 729, 730, 731, 732, 733, 734, 735, 736, 737, 738, 739, 740, 741, 742, 743, 744, 745, 746, 747, 748, 749, 750, 751, 752, 753, 754, 755, 756, 757, 758, 759, 760, 761, 762, 763, 764, 765, 766, 767, 768, 769, 770, 771, 772, 773, 774, 775, 776, 777, 778, 779, 780, 781, 782, 783, 784, 785, 786, 787, 788, 789, 790, 791, 792, 793, 794, 795, 796, 797, 798, 799, 800, 801, 802, 803, 804, 805, 806, 807, 808, 809, 810, 811, 812, 813, 814, 815, 816, 817, 818, 819, 820, 821, 822, 823, 824, 825, 826, 827, 828, 829, 830, 831, 832, 833, 834, 835, 836, 837, 838, 839, 840, 841, 842, 843, 844, 845, 846, 847, 848, 849, 850, 851, 852, 853, 854, 855, 856, 857, 858, 859, 860, 861, 862, 863, 864, 865, 866, 867, 868, 869, 870, 871, 872, 873, 874, 875, 876, 877, 878, 879, 880, 881, 882, 883, 884, 885, 886, 887, 888, 889, 890, 891, 892, 893, 894, 895, 896, 897, 898, 899, 900, 901, 902, 903, 904, 905, 906, 907, 908, 909, 910, 911, 912, 913, 914, 915, 916, 917, 918, 919, 920, 921, 922, 923, 924, 925, 926, 927, 928, 929, 930, 931, 932, 933, 934, 935, 936, 937, 938, 939, 940, 941, 942, 943, 944, 945, 946, 947, 948, 949, 950, 951, 952, 953, 954, 955, 956, 957, 958, 959, 960, 961, 962, 963, 964, 965, 966, 967, 968, 969, 970, 971, 972, 973, 974, 975, 976, 977, 978, 979, 980, 981, 982, 983, 984, 985, 986, 987, 988, 989, 990, 991, 992, 993, 994, 995, 996, 997, 998, 999, 1000.

OPEN SPACE SUMMARY

OPEN SPACES A, C AND D, PROMOTE STORMWATER RETENTION. AREAS FOR ALL OPEN SPACES ARE LISTED BELOW.
 COMMON OPEN SPACE A: ±12.08 AC
 COMMON OPEN SPACE B: ±12.13 AC
 COMMON OPEN SPACE C: ±4.49 AC
 COMMON OPEN SPACE D: ±3.38 AC
TOTAL: ±32.08 AC

SITE STATISTICS

CURRENT ZONING: PRD
 TOTAL SITE AREA: ±63.75 AC
 TOTAL OPEN SPACE: ±32.08 AC
 TOTAL NUMBER OF DWELLING UNITS: 95
 GROSS DENSITY: 1.48 UNITS/AC
 TOTAL DISTURBED AREA: ±50.13 AC
 PRE-DEVELOPED IMPERVIOUS: ±0.35 AC
 POST-DEVELOPED IMPERVIOUS: ±15.64 AC

FLOOD PLAN

ALL OF CLARKSHAW VILLAGE DEVELOPMENT IS IN THE FLOOD HAZARD ZONE X (OUTSIDE OF 0.2% ANNUAL CHANCE FLOOD PLAN) AS SHOWN ON FEDERAL EMERGENCY MANAGEMENT AGENCY FLOOD INSURANCE RATE MAP. MAP NUMBER 390410230K, EFFECTIVE DATE 4/16/2009 (NOT PRINTED)

NOTE

THERE ARE NO KNOWN CEMETERIES, HISTORICAL OR ARCHAEOLOGICAL SITE LOCATED WITHIN THE PROPERTY BOUNDARY.

REFERENCES

EXISTING BASE MAP AND TOPOGRAPHICAL INFORMATION WAS OBTAINED FROM THE DELAWARE COUNTY ENGINEERING DEPARTMENT, NOVEMBER 2024 AND FIELD SURVEY PERFORMED APRIL 2025

OWNER

MARONDA HOMES
 2800 WILCOX ROAD
 DUBLIN, OH 43015
 TEL: (312) 505-4419
 CONTACT: JOHN KONOVODOFF
 EMAIL: JKONOVODOFF@MARONDA.COM

SURVEYOR

CEISO, INC.
 2800 CORPORATE EXCHANGE DR.
 SUITE 400
 COLUMBUS, OH 43235
 TEL: (614) 472-6963
 CONTACT: MATT ACKROYD
 EMAIL: MATT.ACKROYD@CEISOINC.COM

CIVIL ENGINEER

KIMLEY-HORN AND ASSOCIATES, INC.
 2800 CORPORATE EXCHANGE DR.
 SUITE 400
 COLUMBUS, OH 43235
 TEL: (614) 472-6963
 CONTACT: MATT ACKROYD
 EMAIL: MATT.ACKROYD@KIMLEY-HORN.COM

Drawing name: C:\VACC\Projects\KHA\190275001\Maronda\Bldg\Forms\Project\Final\Design\CD\190275001.dwg
 THE SHEET: 190275001.dwg
 DATE: 2/26/2026 4:12pm
 BY: Deloitte

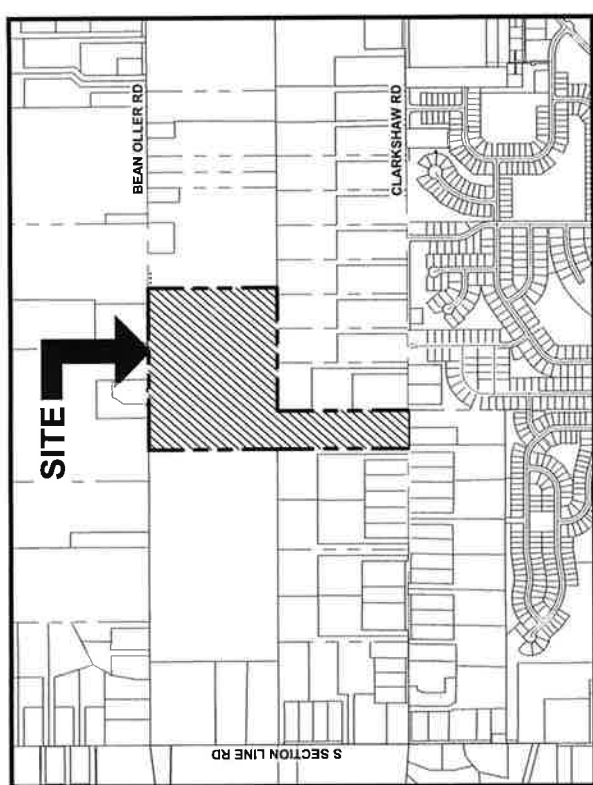

DELAWARE COUNTY APPROVALS

THE DELAWARE COUNTY ENGINEER'S SIGNATURE ON THIS PLAN SIGNIFIES ONLY CONCURRENCE WITH THE GENERAL PURPOSE AND LOCATION OF THE PROPOSED IMPROVEMENTS. ALL TECHNICAL DETAILS PREPARED AND CERTIFIED BY THESE PLANS.

COUNTY ENGINEER
 DELAWARE COUNTY, OHIO

CHIEF OPERATING OFFICER, DEL-CO WATER

ENGINEER'S CERTIFICATION

THIS IS TO CERTIFY THAT GOOD ENGINEERING PRACTICES HAVE BEEN UTILIZED IN THE DESIGN OF THIS PROJECT AND THAT ALL OF THE MINIMUM STANDARDS AS REQUIRED IN THE DELAWARE COUNTY ENGINEERING STANDARDS MANUAL HAVE BEEN MET, INCLUDING THOSE STANDARDS GREATER THAN MINIMUM WHERE, IN MY OPINION, THEY ARE NEEDED TO PROTECT THE SAFETY OF THE PUBLIC. ANY VARIANCE TO THE ABOVE STANDARDS ARE CONSIDERED TO BE NECESSARY TO PROTECT THE PUBLIC SAFETY AND CONVENIENCE. THESE VARIANCES HAVE BEEN LISTED HEREIN AND HAVE BEEN APPROVED BY THE DELAWARE COUNTY SANITARY ENGINEER.

STANDARD CONSTRUCTION DRAWINGS

CITY OF COLUMBUS	DELAWARE COUNTY ENGINEER
DCED-R100	DCED-R2180
DCED-R141A	DCED-S106
DCED-R1450	DCED-S107
DCED-R2010	DCED-S108
DCED-R2020	DCED-S109
DCED-R2135A (M00)	DCED-S110
DCED-R2135C	DCED-S111
DCED-R21350	DCED-S112
DCED-R2175	DCED-S113
DCED-R2185	DCED-S114
DCED-R2200	DCED-S115
DCED-R2201A	DCED-S116
DCED-R2300	DCED-S117
DCED-S100	DCED-S118
DCED-S102	DCED-S119
DCED-S104	DCED-S120
DCED-S105	DCED-S121
DCED-S106	DCED-S122
DCED-S107	DCED-S123
DCED-S108	DCED-S124
DCED-S109	DCED-S125
DCED-S110	DCED-S126
DCED-S111	DCED-S127
DCED-S112	DCED-S128
DCED-S113	DCED-S129
DCED-S114	DCED-S130
DCED-S115	DCED-S131
DCED-S116	DCED-S132
DCED-S117	DCED-S133
DCED-S118	DCED-S134
DCED-S119	DCED-S135
DCED-S120	DCED-S136
DCED-S121	DCED-S137
DCED-S122	DCED-S138
DCED-S123	DCED-S139
DCED-S124	DCED-S140
DCED-S125	DCED-S141
DCED-S126	DCED-S142
DCED-S127	DCED-S143
DCED-S128	DCED-S144
DCED-S129	DCED-S145
DCED-S130	DCED-S146
DCED-S131	DCED-S147
DCED-S132	DCED-S148
DCED-S133	DCED-S149
DCED-S134	DCED-S150
DCED-S135	DCED-S151
DCED-S136	DCED-S152
DCED-S137	DCED-S153
DCED-S138	DCED-S154
DCED-S139	DCED-S155
DCED-S140	DCED-S156
DCED-S141	DCED-S157
DCED-S142	DCED-S158
DCED-S143	DCED-S159
DCED-S144	DCED-S160
DCED-S145	DCED-S161
DCED-S146	DCED-S162
DCED-S147	DCED-S163
DCED-S148	DCED-S164
DCED-S149	DCED-S165
DCED-S150	DCED-S166
DCED-S151	DCED-S167
DCED-S152	DCED-S168
DCED-S153	DCED-S169
DCED-S154	DCED-S170
DCED-S155	DCED-S171
DCED-S156	DCED-S172
DCED-S157	DCED-S173
DCED-S158	DCED-S174
DCED-S159	DCED-S175
DCED-S160	DCED-S176
DCED-S161	DCED-S177
DCED-S162	DCED-S178
DCED-S163	DCED-S179
DCED-S164	DCED-S180
DCED-S165	DCED-S181
DCED-S166	DCED-S182
DCED-S167	DCED-S183
DCED-S168	DCED-S184
DCED-S169	DCED-S185
DCED-S170	DCED-S186
DCED-S171	DCED-S187
DCED-S172	DCED-S188
DCED-S173	DCED-S189
DCED-S174	DCED-S190
DCED-S175	DCED-S191
DCED-S176	DCED-S192
DCED-S177	DCED-S193
DCED-S178	DCED-S194
DCED-S179	DCED-S195
DCED-S180	DCED-S196
DCED-S181	DCED-S197
DCED-S182	DCED-S198
DCED-S183	DCED-S199
DCED-S184	DCED-S200
DCED-S185	DCED-S201
DCED-S186	DCED-S202
DCED-S187	DCED-S203
DCED-S188	DCED-S204
DCED-S189	DCED-S205
DCED-S190	DCED-S206
DCED-S191	DCED-S207
DCED-S192	DCED-S208
DCED-S193	DCED-S209
DCED-S194	DCED-S210
DCED-S195	DCED-S211
DCED-S196	DCED-S212
DCED-S197	DCED-S213
DCED-S198	DCED-S214
DCED-S199	DCED-S215
DCED-S200	DCED-S216
DCED-S201	DCED-S217
DCED-S202	DCED-S218
DCED-S203	DCED-S219
DCED-S204	DCED-S220
DCED-S205	DCED-S221
DCED-S206	DCED-S222
DCED-S207	DCED-S223
DCED-S208	DCED-S224
DCED-S209	DCED-S225
DCED-S210	DCED-S226
DCED-S211	DCED-S227
DCED-S212	DCED-S228
DCED-S213	DCED-S229
DCED-S214	DCED-S230
DCED-S215	DCED-S231
DCED-S216	DCED-S232
DCED-S217	DCED-S233
DCED-S218	DCED-S234
DCED-S219	DCED-S235
DCED-S220	DCED-S236
DCED-S221	DCED-S237
DCED-S222	DCED-S238
DCED-S223	DCED-S239
DCED-S224	DCED-S240
DCED-S225	DCED-S241
DCED-S226	DCED-S242
DCED-S227	DCED-S243
DCED-S228	DCED-S244
DCED-S229	DCED-S245
DCED-S230	DCED-S246
DCED-S231	DCED-S247
DCED-S232	DCED-S248
DCED-S233	DCED-S249
DCED-S234	DCED-S250
DCED-S235	DCED-S251
DCED-S236	DCED-S252
DCED-S237	DCED-S253
DCED-S238	DCED-S254
DCED-S239	DCED-S255